

**From:** Tucker Matt: H&F

**Sent:** 23 April 2025 14:39

**To:** [REDACTED]

**Subject:** RE: Comments for Licensing Application 2025/00574/LAPR

Dear [REDACTED] – thank you for your comments (below) and I hope you are well.

I have attached a copy of the application form, premises plan and location maps for your reference. Page 1 of the maps shows the location of the overall site (under the flyover) and Page 2 shows the individual building concerned (H1). The site is, as I understand it, currently under construction.

The application proposed that a premises licence is sought (as opposed to a club premises certificate where only club members, rather than the public at large could enter) and the proposed hours include being open to the public. I cannot speak to the Applicant's reasons for seeking these hours, but would comment that they are entitled to apply for whatever hours they would like. Ultimately, if we receive any valid objections, we would have to call a Licensing Sub-Committee Hearing who would ultimately make a decision on the application.

With reference to your wider points about the *“protective scheme that applies to the Shepherd's Bush Ward, Shepherd's Green and Uxbridge Road areas”*. Hammersmith and Fulham do not have any of what we would classify Cumulative Impact Zones (CIZs) designed to limit the number of premises. Therefore, presumption under the Licensing Act 2003 (the Act), would be in favour of granting, unless there were credible reasons for a Sub-Committee not approving an application.

I hope this clarifies further and, should you have any other comments to make on this application, I would recommend providing these to me by midnight on 14 May 2025.

Kind regards

**Matt Tucker**

**Interim Licensing Policy and Administration Team Leader**

Licensing

Place Department

Hammersmith & Fulham Council

**T:** 07778 966423

**E:** [Matt.Tucker@lbhf.gov.uk](mailto:Matt.Tucker@lbhf.gov.uk)

**W:** [www.lbhf.gov.uk](http://www.lbhf.gov.uk)

**Application for a premises licence to be granted under the Licensing Act 2003**

Case number	2025/00574/LAPR
Payment transaction reference	256 30112
Amount paid	£315
Date submitted	16/04/2025
Are you the applicant or their agent?	Agent

**PREMISES DETAILS**

Premises address

If the premises could not be found please enter the address here, or if the premises has no address give a detailed description (including the Ordnance Survey references)

Imperial College White City Innovation District  
H1 Building  
Wood Lane  
London  
W12

Trading name (if any)

Telephone number at the premises (if any)

Are the premises in the course of construction?

Yes

Non domestic rateable value of the premises	33001
---	-------

Will the premises be exclusively or primarily used for the supply of alcohol for consumption on the premises?

No

**APPLICANT DETAILS**

I am applying as	the proprietor of an educational establishment
------------------	--

Applicant name	Imperial College of Science, Technology And Medicine
----------------	---

Address	c/o Thomas & Thomas Partners LLP 38a Monmouth Street London WC2H 9EP
---------	---

Registered company number	RC000231
---------------------------	----------

Telephone number

Email address

**Alternative details for correspondence**

Contact name (if different from premises user)	Mr R P
--	--------

Business name	Thomas & Thomas Partners LLP
---------------	------------------------------

Correspondence address	Thomas & Thomas Partners LLP 38a Monmouth Street London WC2H 9EP
------------------------	---

Daytime/ business telephone number



Evening/ home telephone number

Mobile phone number

Email address

## **OPERATING SCHEDULE**

When do you want the premises licence to start?

14/05/2025

If you want the licence to be valid for only a limited period, when do you want it to end?

If 5,000 or more people are expected to attend the premises at any one time, please state the number expected to attend

Please give a general description of the premises.

Licensed facilities as part of Imperial College White City Innovation District.

What licensable activities do you intend to carry on from the premises?

films, live music, recorded music, performances of dance, anything similar, late night refreshment, supply of alcohol

## **HOURS OPEN TO THE PUBLIC**

Standard days

### **Mondays**

Start 11:00

Finish 01:00

### **Tuesdays**

Start 11:00

Finish 01:00

### **Wednesdays**

Start 11:00

Finish 02:00

### **Thursdays**

Start 11:00

Finish 03:00

### **Fridays**

Start 11:00

Finish 03:00

### **Saturdays**

Start 11:00

Finish 03:00

### **Sundays**

Start 11:00

Finish 00:00

Please state any seasonal variations

Non standard timings. Where you intend to use the premises at different times to those listed above, please list

From the end of permitted hours on New Year's Eve to the start of permitted hours on New Year's Day.

Sundays before Bank Holidays 11:00 03:00

## **FILMS**

Please give further details here

Will the performance of films take place indoors, outdoors or both?

Both

Standard days

### **Mondays**

Start 11:00

Finish 01:00

### **Tuesdays**

Start 11:00

Finish 01:00

### **Wednesdays**

Start 11:00

Finish 02:00

### **Thursdays**

Start 11:00

Finish 03:00

### **Fridays**

Start 11:00

Finish 03:00

### **Saturdays**

Start 11:00

Finish 03:00

### **Sundays**

Start 11:00

Finish 00:00

Please state any seasonal variations

Non standard timings. Where you intend to use the premises for films at different times to those listed above, please list.

From the end of permitted hours on New Year's Eve to the start of permitted hours on New Year's Day.

Sundays before Bank Holidays 11:00 03:00

## **LIVE MUSIC**

Please give further details here

Will the performance of live music take place indoors, outdoors or both?

Both

Standard days

### **Mondays**

Start 11:00

Finish 01:00

**Tuesdays**

Start	11:00
Finish	01:00

**Wednesdays**

Start	11:00
Finish	02:00

**Thursdays**

Start	11:00
Finish	03:00

**Fridays**

Start	11:00
Finish	03:00

**Saturdays**

Start	11:00
Finish	03:00

**Sundays**

Start	11:00
Finish	00:00

Please state any seasonal variations

Non standard timings. Where you intend to use the premises for live music at different times to those listed above, please list.

From the end of permitted hours on New Year's Eve to the start of permitted hours on New Year's Day.

Sundays before Bank Holidays 11:00 03:00

**RECORDED MUSIC**

Please give further details here

Will the performance of recorded music take place indoors, outdoors or both?

Both

Standard days

**Mondays**

Start	11:00
Finish	01:00

**Tuesdays**

Start	11:00
Finish	01:00

**Wednesdays**

Start	11:00
Finish	02:00

**Thursdays**

Start	11:00
Finish	03:00

**Fridays**

Start	11:00
-------	-------

Finish 03:00

**Saturdays**

Start 11:00

Finish 03:00

**Sundays**

Start 11:00

Finish 00:00

Please state any seasonal variations

Non standard timings. Where you intend to use the premises for recorded music at different times to those listed above, please list.

From the end of permitted hours on New Year's Eve to the start of permitted hours on New Year's Day.

Sundays before Bank Holidays 11:00 03:00

**PERFORMANCES OF DANCE**

Please give further details here

Will the performance of dance take place indoors, outdoors or both?

Both

Standard days

**Mondays**

Start 11:00

Finish 01:00

**Tuesdays**

Start 11:00

Finish 01:00

**Wednesdays**

Start 11:00

Finish 02:00

**Thursdays**

Start 11:00

Finish 03:00

**Fridays**

Start 11:00

Finish 03:00

**Saturdays**

Start 11:00

Finish 03:00

**Sundays**

Start 11:00

Finish 00:00

Please state any seasonal variations

Non standard timings. Where you intend to use the premises for performances of dance at different times to those listed above, please list.

From the end of permitted hours on New Year's Eve to the start of permitted hours on New Year's Day.

Sundays before Bank Holidays 11:00 03:00

### **ANYTHING SIMILAR TO LIVE MUSIC, RECORDED MUSIC OR DANCE**

Please give further details here

Will this entertainment take place indoors, outdoors or both?

Both

Standard days

#### **Mondays**

Start 11:00

Finish 01:00

#### **Tuesdays**

Start 11:00

Finish 01:00

#### **Wednesdays**

Start 11:00

Finish 02:00

#### **Thursdays**

Start 11:00

Finish 03:00

#### **Fridays**

Start 11:00

Finish 03:00

#### **Saturdays**

Start 11:00

Finish 03:00

#### **Sundays**

Start 11:00

Finish 00:00

Please state any seasonal variations

Non standard timings. Where you intend to use the premises for this entertainment at different times to those listed above, please list.

From the end of permitted hours on New Year's Eve to the start of permitted hours on New Year's Day.

Sundays before Bank Holidays 11:00 03:00

### **LATE NIGHT REFRESHMENT**

Please give further details here

Will the provision of late night refreshment take place indoors, outdoors or both?

Both

Standard days

#### **Mondays**

Start 23:00

Finish 01:00

**Tuesdays**

Start 23:00

Finish 01:00

**Wednesdays**

Start 23:00

Finish 02:00

**Thursdays**

Start 23:00

Finish 03:00

**Fridays**

Start 23:00

Finish 03:00

**Saturdays**

Start 23:00

Finish 03:00

**Sundays**

Start 23:00

Finish 00:00

Please state any seasonal variations

Non standard timings. Where you intend to use the premises for late night refreshment at different times to those listed above, please list.

From the end of permitted hours on New Year's Eve to the start of permitted hours on New Year's Day.

Sundays before Bank Holidays 23:00 03:00

**SUPPLY OF ALCOHOL**

Please give further details here

Will the supply of alcohol be for consumption on the premises, off the premises or both?

Both

Standard days

**Mondays**

Start 11:00

Finish 01:00

**Tuesdays**

Start 11:00

Finish 01:00

**Wednesdays**

Start 11:00

Finish 02:00

**Thursdays**

Start 11:00

Finish 03:00

**Fridays**



Start	11:00
Finish	03:00

**Saturdays**

Start	11:00
Finish	03:00

**Sundays**

Start	11:00
Finish	00:00

Please state any seasonal variations

Non standard timings. Where you intend to use the premises for the supply of alcohol at different times to those listed above, please list.

From the end of permitted hours on New Year's Eve to the start of permitted hours on New Year's Day.

Sundays before Bank Holidays 11:00 03:00

**Details of the individual whom you wish to specify on the licence as the designated premises supervisor**

Full name	Mr James Honeyman
-----------	-------------------

Date of birth	[REDACTED]
---------------	------------

Home address of prospective designated premises supervisor	[REDACTED] [REDACTED] [REDACTED]
--	--

Personal licence number (if known)	TBC
------------------------------------	-----

Issuing authority (if known)

Please highlight any adult entertainment or services, activities, other entertainment or matters ancillary to the use of the premises that may give rise to concern in respect of children

Describe the steps you intend to take to promote the licensing objectives

a) General all four licensing objectives (b,c,d and e)

Please see appended operating schedule of proposed conditions to address all four licensing objectives. The application follows pre-application advice and site meeting with both Licensing and Environmental Health Officers.

b) The prevention of crime and disorder

See a) above

c) Public safety

See a) above

d) The prevention of public nuisance

See a) above

e) The protection of children from harm

See a) above

**DECLARATIONS**

I have enclosed a plan of the premises

Yes

I have enclosed the consent form completed by the individual I wish to be designated premises supervisor

Yes

I understand I must now advertise my application

Yes

It is an offence, under section 158 of the Licensing Act 2003, to make a false statement in or in connection with this application. Those who make a false statement may be liable on summary conviction to a fine of any amount.

It is an offence under section 24b of the Immigration Act 1971 for a person to work when they know, or have reasonable cause to believe, that they are disqualified from doing so by reason of their immigration status. Those who employ an adult without leave or who is subject to conditions as to employment will be liable to a civil penalty under section 15 of the Immigration, Asylum And Nationality Act 2006 and pursuant to section 21 of the same act, will be committing an offence where they do so in the knowledge, or with reasonable cause to believe, that the employee is disqualified.

The DPS named in this application form is entitled to work in the UK (and is not subject to conditions preventing him or her from doing work relating to a licensable activity) and I have seen a copy of his or her proof of entitlement to work, or have conducted an online right to work check using the Home Office online right to work checking service which confirmed their right to work.

I have the consent of any individuals or third parties listed in this form to provide their personal details and I am authorised to submit this application on behalf of all applicants.

I have read the privacy policy and agree for my details to be used by the council to contact me about this application and any changes to this service that may affect me.

I agree to the above

Yes I agree to the above declaration

Full name

Thomas & Thomas Partners LLP

Capacity

Solicitors on behalf of applicant

Date

16/04/2025



**Note: Sprinklers are to be provided throughout the building in line with BS EN 12845 and the basebuild fire strategy.**

Key

- 
- Indicative partition and door layout by operator, not part of basebuild
- 
- Fire rated door
- 
- Fire rated door - keep locked
- 
- Fire Exit Sign Potential Locations  
(to be confirmed by operator as part of fire risk assessment process)
- 
- Entrance and Exit
- 
- Fire Exit
- 
- Mechanical Smoke Extraction
- 
- Fire Alarm Call Point Potential Locations  
(to be confirmed by operator as part of fire alarm installation design)
- 
- Fire Extinguisher Potential Locations  
(number type and sizes to be confirmed by operator as part of fire risk assessment process)
- 
- Area of Licensable Activities

Drawing Notes

No dimensions are to be scaled from this drawing. The contractor / manufacturer is responsible for checking all dimensions and querying any discrepancies.

Copyright TurnerWorks.  
Copyright is reserved by them and the drawing is issued on condition that it is not copied, reproduced, retained or disclosed to any unauthorised person, either wholly or in part, without written consent.

To be read in conjunction with specialist consultant information (Fire Engineer, MEP, Structural Engineer etc.) Exit signage, emergency lighting, fire alarms and detection to adhere to relevant building regulations and British Standards. Refer to internal and external door schedules for door and ironmongery requirements.

Scale Bar

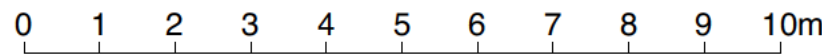

P02	Issue for Licensing	JR	04/04/2025
P01	Draft Issue for Licencing	JR	27/03/2025

Rev	Description	By	Date
-----	-------------	----	------

Client

IMPERIAL

Designer

Turner.Works

Contractor

Imperial Project No.

WCSZZ2400

Imperial Project Title

DZ1 Buildings H1 & H2

Building Name

DZ1 Buildings H1 & H2

Campus

White City

Drawing Title

H1 Licensing Plan - Level G

Status	Purpose of Issue
S5	Issue for Licencing

Drawn by	Checked	Scale @ A1	Date
JR	MF	1:100	27/03/2025

Drawing Number							
Proj	Orig	Zone	Level	Type	Role	No.	Rev
WCSZZ2400	TUR	H1	G	DR	A	06125	P02

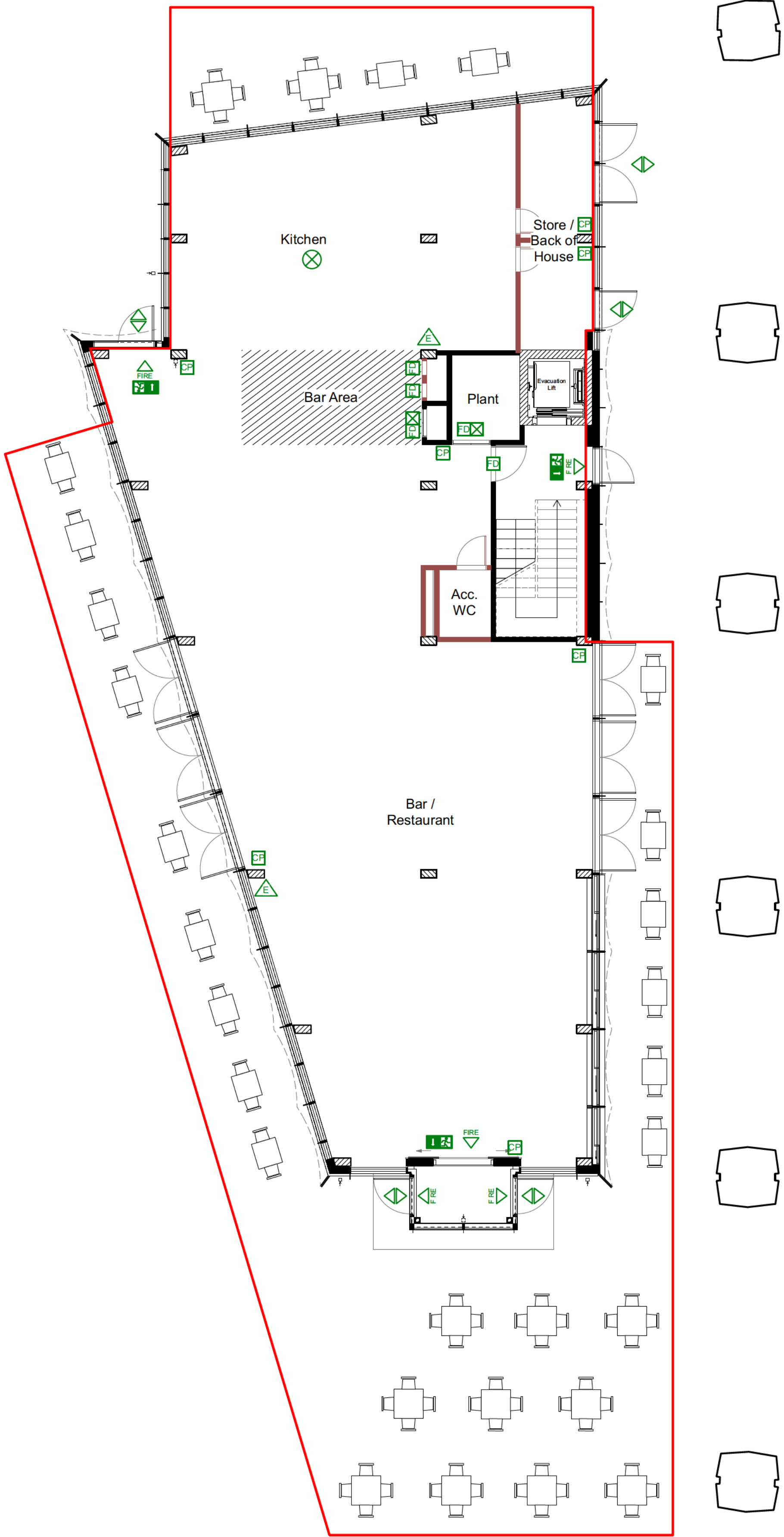



**Note: Sprinklers are to be provided throughout the building in line with BS EN 12845 and the basebuild fire strategy.**

Key

- 
- 
- 
- 
- 
- 
- 
- 
- 
- 
- Indicative partition and door layout by operator, not part of basebuild
- Fire rated door
- Fire rated door - keep locked
- Fire Exit Sign Potential Locations  
(to be confirmed by operator as part of fire risk assessment process)
- Entrance and Exit
- Fire Exit
- Mechanical Smoke Extraction
- Fire Alarm Call Point Potential Locations  
(to be confirmed by operator as part of fire alarm installation design)
- Fire Extinguisher Potential Locations  
(number type and sizes to be confirmed by operator as part of fire risk assessment process)
- Area of Licensable Activities

Drawing Notes

No dimensions are to be scaled from this drawing. The contractor / manufacturer is responsible for checking all dimensions and querying any discrepancies.

Copyright TurnerWorks.  
Copyright is reserved by them and the drawing is issued on condition that it is not copied, reproduced, retained or disclosed to any unauthorised person, either wholly or in part, without written consent.

To be read in conjunction with specialist consultant information (Fire Engineer, MEP, Structural Engineer etc.) Exit signage, emergency lighting, fire alarms and detection to adhere to relevant building regulations and British Standards. Refer to internal and external door schedules for door and ironmongery requirements.

Scale Bar

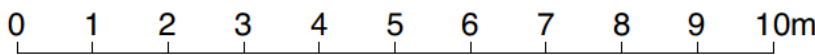

P02	Issue for Licensing	JR	04/04/2025
P01	Draft Issue for Licencing	JR	27/03/2025

Rev	Description	By	Date
-----	-------------	----	------

Client

IMPERIAL

Designer

Turner.Works

Contractor

Imperial Project No.

WCSZZ2400

Imperial Project Title

DZ1 Buildings H1 & H2

Building Name

DZ1 Buildings H1 & H2

Campus

White City

Drawing Title

H1 Licensing Plan - Level 01

Status	Purpose of Issue
S5	Issue for Licencing

Drawn by	Checked	Scale @ A1	Date
JR	MF	1:100	27/03/2025

Drawing Number						
Proj	Orig	Zone	Level	Type	Role	No. Rev
WCSZZ2400	TUR	H1	01	DR	A	06126 P02



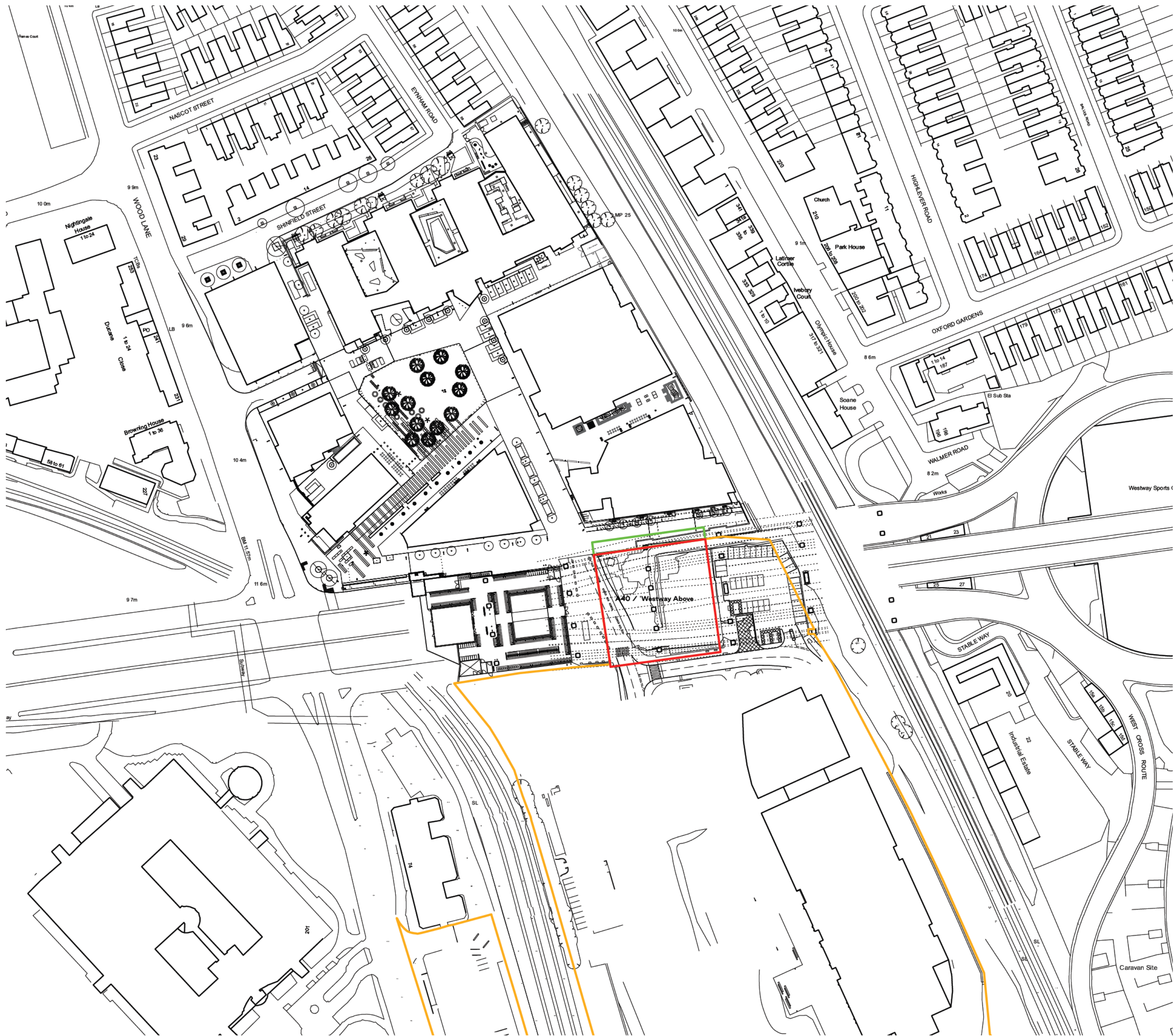

**Key**

Site Boundary (RMA)

Site Boundary (OPP)

Site Boundary (Associated Full Planning Application 'Northern Works')

Note: Permission is sought for works on this site in a separate Full Planning application submitted concurrently to this RMA.

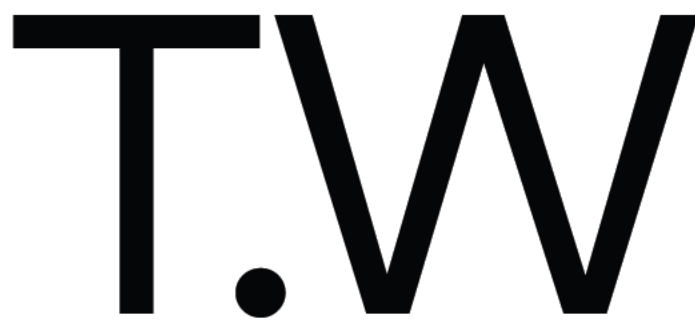

TurnerWorks  
Block D, Echo Building  
Hackney Bridge  
London E15 2SJ  
  
020 3846 1890  
hello@turner.works

Revision History		
Rev	Date	Description
P01	23/04/2024	Planning Draft for Comment
C01	24/04/2024	Planning Issue

**Notes**

No dimensions are to be scaled from this drawing. The contractor / manufacturer is responsible for checking all dimensions and querying any discrepancies.

To be read in conjunction with specialist consultant information (MEP, Structural Engineer etc.)

Copyright TurnerWorks.  
Copyright is reserved by them and the drawing is issued on condition that it is not copied, reproduced, retained or disclosed to any unauthorised person, either wholly or in part, without written consent.

**Orientation & Scale**

012.52537.55062.57587.5100m

<b>Project</b>	DZ1 Buildings H1 & H2	<b>Drawn by</b>	JR
<b>Drawing Title</b>	Existing Site Location Plan	<b>Date</b>	24/04/2024
		<b>Scale</b>	1:1250 @A1 1:2500 @A3
		<b>Status</b>	S5
<b>Drawing No.</b>	WCSZZ2400-TUR-ZZ-XX-DR-A-07001		





**Key**

- Site Boundary (RMA)
- Site Boundary (OPP)
- Site Boundary (Associated Full Planning Application 'Northern Works')

Note: Proposals contained within this boundary are shown for information. Permission is sought for these works in a separate Full Planning application submitted concurrently to this RMA.

Indicative landscape proposal shown beyond site boundary for continuity. Not part of group of applications, permission not sought for these works.

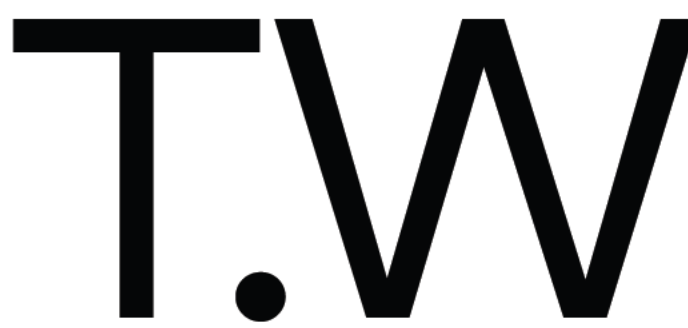

Turner.Works  
Block D, Echo Building  
Hackney Bridge  
London E15 2SJ  
  
020 3846 1890  
hello@turner.works

Revision History		
Rev	Date	Description
P01	23/04/2024	Planning Draft for Comment
C01	24/04/2024	Planning Issue

**Notes**

No dimensions are to be scaled from this drawing. The contractor / manufacturer is responsible for checking all dimensions and querying any discrepancies

Copyright Turner.Works. Copyright is reserved by them and the drawing is issued on condition that it is not copied, reproduced, retained or disclosed to any unauthorised person, either wholly or in part, without written consent.

To be read in conjunction with specialist consultant information (MEP, Structural Engineer etc.)

Landscape is shown indicatively only. Refer to Landscape Architect's information for more detail.

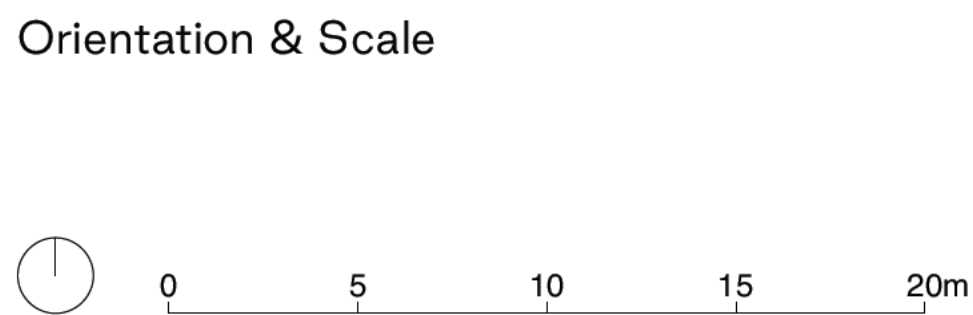

Project	DZ1 Buildings H1 & H2		Drawn by	JR
Drawing Title	Proposed Block Plan	Rev. C01	Date	24/04/2024
			Scale	1:200 @A1 1:400@A3
			Status	S5
			Drawing No. WCSZZ2400-TUR-ZZ-XX-DR-A-07015	



**From:** Tucker Matt: H&F

**Sent:** 27 May 2025 18:11

**To:** [REDACTED]

**Subject:** RE: Comments for Licensing Application 2025/00574/LAPR

Dear [REDACTED] – I hope you are keeping well.

Following the close of the consultation, I have been asked to attach a copy of conditions agreed with the Met Police, as well as contact details for the Applicant, as follows:

**Ryan Peermamode**  
**CILEX Paralegal**

**Thomas & Thomas Partners LLP**  
**38a Monmouth Street, London, WC2H 9EP**  
**D: 020 7042 0417**  
**E: [rpeermamode@tandtp.com](mailto:rpeermamode@tandtp.com)**  
**W: [www.tandtp.com](http://www.tandtp.com)**

Should this mitigate your concerns, to the extent that you wish to withdraw your representation, please let me know by way of return e-mail.

Kind regards

**Matt Tucker**  
**Interim Licensing Policy and Administration Team Leader**  
Licensing  
Place Department  
Hammersmith & Fulham Council

**T:** 07778 966423  
**E:** [Matt.Tucker@lbhf.gov.uk](mailto:Matt.Tucker@lbhf.gov.uk)  
**W:** [www.lbhf.gov.uk](http://www.lbhf.gov.uk)

**From:** Sondh Nicole K - AW-CU **On Behalf Of** AW Mailbox - Licensing FH

**Sent:** 30 April 2025 15:33

**To:** Licensing HF: H&F <[licensing@lbhf.gov.uk](mailto:licensing@lbhf.gov.uk)>

**Cc:** Alun Thomas <[athomas@tandtp.com](mailto:athomas@tandtp.com)>; Pablo Pimienta <[pablo@riviera-re.com](mailto:pablo@riviera-re.com)>;  
Environmental Protection: H&F <[noise@lbhf.gov.uk](mailto:noise@lbhf.gov.uk)>

**Subject:** FW: New Premises Licence Application - Imperial College White City  
Innovation District, H1 Building, Wood Lane, London, W12 - 2025/00574/LAPR

Good Afternoon Licensing,

**RE: New Premises Licence Application - Imperial College White City Innovation District, H1 Building, Wood Lane, London, W12 - 2025/00574/LAPR**

Please see the below condition agreed with the applicant in relation to the above New Premises Licence Application.

- 1. On days when the premises is open after 00:00 the premises will risk assess the need for SIA door staff. A copy of the risk assessment shall be kept for a period of 12 months and provided to police or an officer of the council upon request.**

Kind Regards

Nicole

PC Nicole SONDH 2438AW

Hammersmith and Fulham Police Licensing Unit

**Address:** Hammersmith and Fulham Police Station, 226 Shepherds Bush Road,  
London, W6 7NX

**Email:** [nicole.sondh@met.pnn.police.uk](mailto:nicole.sondh@met.pnn.police.uk)



[Click here for Drink Spike Prevention and Ask for Angela materials](#)

[Click here for drink spiking advice](#)



**From:** Tucker Matt: H&F

**Sent:** 16 June 2025 17:40

**To:** [REDACTED]

**Subject:** FW: Comments for Licensing Application 2025/00574/LAPR

Dear [REDACTED]

I hope you are well and am just touching base to check you received the message of 27 May 2025 below?

Kind regards

**Matt Tucker**

**Interim Licensing Policy and Administration Team Leader**

Licensing

Place Department

Hammersmith & Fulham Council

**T:** 07778 966423

**E:** [Matt.Tucker@lbhf.gov.uk](mailto:Matt.Tucker@lbhf.gov.uk)

**W:** [www.lbhf.gov.uk](http://www.lbhf.gov.uk)