

Application for a premises licence to be granted under the Licensing Act 2003

Case number 2024/00422/LAPR

Payment transaction reference 256 80560

Amount paid £100

Date submitted 11/03/2024

Are you the applicant or their agent? Applicant

PREMISES DETAILS

Premises address

21 Effie Road, London SW6 1EN

If the premises could not be found please enter the address here, or if the premises has no address give a detailed description (including the Ordnance Survey references)

Trading name (if any) Booze Delivery Limited

Telephone number at the premises (if any)

Are the premises in the course of construction?

No

Non-domestic rateable value if the premises 0

Will the premises be exclusively or primarily used for the supply of alcohol for consumption on the premises?

No

APPLICANT DETAILS

I am applying as an individual or individuals

Title Mr

Name SIDDHARTH CHAUHAN

Address

Date of birth

Nationality

Where applicable, your 9 digit sharecode

Daytime/ business telephone number

Evening/ home telephone number

Mobile phone number

Email address

I confirm that:

I am carrying on or proposing to carry on a business which involves the use of the premises for licensable activities

**Alternative details for
correspondence**

Contact name (if different
from premises user)

Business name

Correspondence address

Daytime/ business telephone
number

Evening/ home telephone
number

Mobile phone number

Email address

OPERATING SCHEDULE

When do you want the premises licence to start?

11/04/2024

If you want the licence to be valid for only a limited period, when do you want it to end?

If 5,000 or more people are expected to attend the premises at any one time, please state the number expected to attend

Please give a general description of the premises.

The premise is a self storage, We hired 1 Unit(4606) and we apply for off-the premises sale/supply of Alcohol.

We work with online platforms to deliver orders using own delivery drivers.

Premises fully cctv covered and has keypad entry and exit.

What licensable activities do you intend to carry on from the premises?

supply of alcohol

HOURS OPEN TO THE PUBLIC

Standard days

Mondays

Start

Finish

Tuesdays

Start

Finish

Wednesdays

Start

Finish

Thursdays

Start

Finish

Fridays

Start

Finish

Saturdays

Start

Finish

Sundays

Start

Finish

Please state any seasonal variations

Non standard timings. Where you intend to use the premises at different times to those listed above, please list

SUPPLY OF ALCOHOL

Please give further details here

This premises is used for off premises sale of Alcohol, monitored with 24 hours cctv recorded and security locked gates. We use our own delivery drivers to deliver orders to customers' bonafide addresses. This premises is not allowed by general public to access.

Will the supply of alcohol be for consumption on the premises, off the premises or both?

Off the premises

Standard days

Mondays

Start 00:00

Finish 23:59 00:00

Tuesdays

Start 00:00

Finish 23:59 00:00

Wednesdays

Start 00:00

Finish 23:59 00:00

Thursdays

Start 00:00

Finish 23:59 00:00

Fridays

Start 00:00

Finish 23:59 00:00

Saturdays

Start 00:00

Finish 23:59 00:00

Sundays

Start 00:00

Finish 23:59 00:00

Please state any seasonal variations

N/A

Non standard timings. Where you intend to use the premises for the supply of alcohol at different times to those listed above, please list.

N/A

Details of the individual whom you wish to specify on the licence as the designated premises supervisor

Full name Mr SIDDHARTH CHAUHAN

Date of birth

[REDACTED]

Home address of prospective designated premises supervisor

[REDACTED]

Personal licence number (if known) LN/000014309/2020/2

Issuing authority (if known) London Borough Of Harrow

Please highlight any adult entertainment or services, activities, other entertainment or matters ancillary to the use of the premises that may give rise to concern in respect of children

Describe the steps you intend to take to promote the licensing objectives

a) General all four licensing objectives (b,c,d and e)

The premises is gated and all time locked with 24 hour cctv monitoring and only authorised person can enter the premises and premises is never open to public. So there is no harm to any of the 4 licensing objectives.

b) The prevention of crime and disorder

The premises is not open to public and we only supply off the premises and upon delivery we ask for individual's valid photo ID.

c) Public safety

No public is allowed in premises and we receive orders only on online platforms such as Deliveroo & Uber Eats. We only deliver to person who orders items by verifying their photo ID. We also have public liability insurance.

d) The prevention of public nuisance

We only use our own drivers to make deliveries and not deliveroo or uber eats bike riders. So our staff is fully trained and they drive a van.

e) The protection of children from harm

We check photo ID upon delivery and if person looks under aged order will be cancelled and be recorded in system.

DECLARATIONS

I have enclosed a plan of the premises

Yes

I have enclosed the consent form completed by the individual I wish to be designated premises supervisor

Yes

I have included documents demonstrating my entitlement to work in the United Kingdom or my share code issued by the Home Office online right to work checking service (Applicable to all individual applicants, including those in a partnership which is not a limited liability partnership, but not companies or limited liability partnerships).

I understand I must now advertise my application

Yes

It is an offence, under section 158 of the Licensing Act 2003, to make a false statement in or in connection with this application. Those who make a false statement may be liable on summary conviction to a fine of any amount.

It is an offence under section 24b of the Immigration Act 1971 for a person to work when they know, or have reasonable cause to believe, that they are disqualified from doing so by reason of their immigration status. Those who employ an adult without leave or who is subject to conditions as to employment will be liable to a civil penalty under section 15 of the Immigration, Asylum And Nationality Act 2006 and pursuant to section 21 of the same act, will be committing an offence where they do so in the knowledge, or with reasonable cause to believe, that the employee is disqualified.

Applicable to individual applicants only, including those in a partnership which is not a limited liability partnership] I understand I am not entitled to be issued with a licence if I do not have the entitlement to live and work in the UK (or if I am subject to a condition preventing me from doing work relating to the carrying on of a licensable activity) and that my licence will become invalid if I cease to be entitled to live and work in the UK.

The DPS named in this application form is entitled to work in the UK (and is not subject to conditions preventing him or her from doing work relating to a licensable activity) and I have seen a copy of his or her proof of entitlement to work, or have conducted an online right to work check using the Home Office online right to work checking service which confirmed their right to work.

I have the consent of any individuals or third parties listed in this form to provide their personal details and I am authorised to submit this application on behalf of all applicants.

I have read the privacy policy and agree for my details to be used by the council to contact me about this application and any changes to this service that may affect me.

I agree to the above

Yes I agree to the above declaration

Full name

Siddharth Chauhan

Capacity

Date

11/03/2024





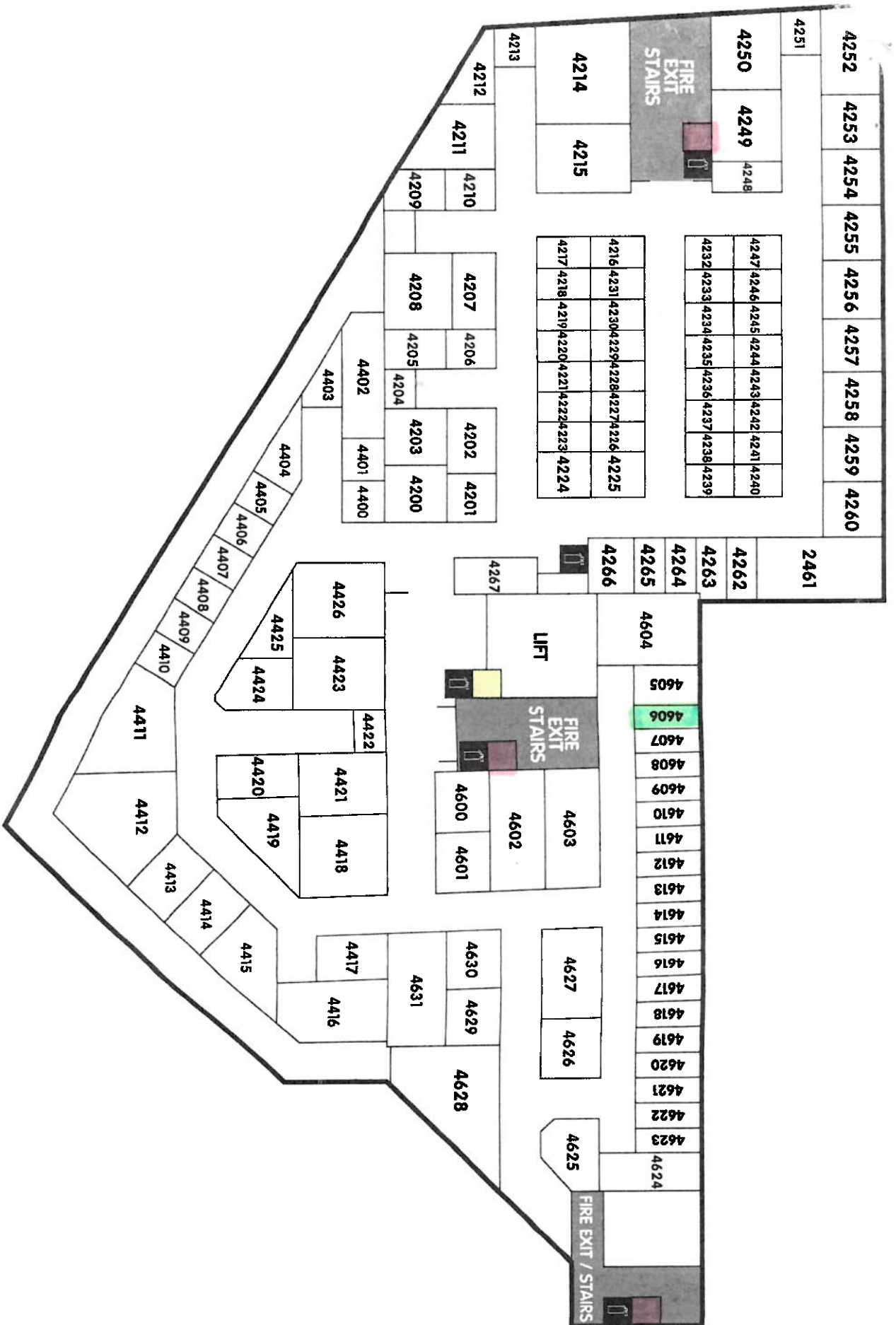

GROUND FLOOR PLAN

-  FIRE EXIT
-  CALL POINT
-  HELP PHONE
-  FIRE EXTINGUISHER



SECOND FLOOR PLAN

-  FIRE EXIT
-  CALL POINT
-  HELP PHONE
-  FIRE EXTINGUISHER

Re: Licensing Act 2003 - Licensing Act - Premises Licence application number: 2024/00422/LAPR



Siddharth Chauhan

To Licensing HF: H&F



Reply



Reply All



Forward



...

Tue 12/03/2024 18:25

William Dealing with

You replied to this message on 13/03/2024 09:26.



Scan 12 Mar 2024.pdf

1 MB



Dear Mr Asante,

I apologise for not clarifying our business model appropriately; so let me take you in brief to explain the business timings we applied for.

We work with Deliveroo and Uber Eats so we have been given a tablet and a market place on their platform so customers can place an order and received by us directly on the tablet given by them. But instead of using their delivery bike riders we use our own delivery van drivers to deliver orders. So as we use our own vans we upload our vans only one in a day during their opening hours but as we have everything needed for the day to fulfil our orders we operate 24 hours a day which doesn't need drivers to go in warehouse for every order. I as a DPS officer present at the time of uploading make sure we have everything in van in terms of stock uploaded in right quantity.

And in regards to opening times applied we would like to apply for 24 hours so I would say 00:00 to 00:00, 7 days of the week throughout the year.

Here below I attach amended consent form in attachments.

Thank you for reaching out to us and correcting the mistake.

Please get in touch if any query.

Thank you,
Siddharth Chauhan
Booze Delivery Limited