

Licensing Act 2003

Premises Licence



Premises Licence Number: 2022/00861/LAPR

Part 1 – Premises details

Postal address of premises, or if none, OS map reference or description of the premises

East African Cuisine
335 North End Road

Post town: London

Post code: SW6 1NN

Telephone:

Where the licence is time limited the dates:

Not Applicable

Licensable activities authorised by the licence:

Provision of Late Night Refreshment -Both Indoors and Outdoors
Sale of Alcohol Both On and Off the Premises

The licence authorises the carrying out of the following licensable activities on the days and at the times specified below:

Provision of Late Night Refreshment -Both Indoors and Outdoors
Monday to Sunday 23:00 - 00:00

Sale of Alcohol Off the Premises
Monday to Sunday 12:00 - 00:00

Sale of Alcohol On the Premises
Monday to Sunday 12:00 - 23:30

The opening hours of the premises:

Monday to Sunday 08:00 - 00:00

Where the licence authorises supplies of alcohol whether these are on and/or off supplies:

Both on and off the premises

Part 2

Name, (registered) address, telephone number and email (where relevant) of holder of premises licence:

Mr Minasie Ghebremariam

[REDACTED]

[REDACTED]

[REDACTED]

Telephone: [REDACTED]

Email: [REDACTED]

Registered number of holder, for example company number, charity number (where applicable):

Not Applicable

Name, address and telephone number of designated premises supervisor where the premises licence authorises the supply of alcohol:

Mr Minasie Ghebremariam

[REDACTED]

[REDACTED]

[REDACTED]

Licensing Authority: Hammersmith And Fulham Council

Personal Licence Number: 2020/00920/LAPER

Annex 1 – Mandatory Conditions

1. Mandatory Condition

(1) The responsible person must ensure that staff on relevant premises do not carry out, arrange or participate in any irresponsible promotions in relation to the premises.

(2) In this paragraph, an irresponsible promotion means any one or more of the following activities, or substantially similar activities, carried on for the purpose of encouraging the sale or supply of alcohol for consumption on the premises—

(a) games or other activities which require or encourage, or are designed to require or encourage, individuals to—

- (i) drink a quantity of alcohol within a time limit (other than to drink alcohol sold or supplied on the premises before the cessation of the period in which the responsible person is authorised to sell or supply alcohol), or
- (ii) drink as much alcohol as possible (whether within a time limit or otherwise);

(b) provision of unlimited or unspecified quantities of alcohol free or for a fixed or discounted fee to the public or to a group defined by a particular characteristic in a manner which carries a significant risk of undermining a licensing objective;

(c) provision of free or discounted alcohol or any other thing as a prize to encourage or reward the purchase and consumption of alcohol over a period of 24 hours or less in a manner which carries a significant risk of undermining a licensing objective;

(d) selling or supplying alcohol in association with promotional posters or flyers on, or in the vicinity of, the premises which can reasonably be considered to condone, encourage or glamorise anti-social behaviour or to refer to the effects of drunkenness in any favourable manner;

(e) dispensing alcohol directly by one person into the mouth of another (other than where that other person is unable to drink without assistance by reason of disability).

2. Mandatory Condition

The responsible person shall ensure that free potable water is provided on request to customers where it is reasonably available.

3. Mandatory Condition

1) The premises licence holder or club premises certificate holder must ensure that an age verification policy is adopted in respect of the premises in relation to the sale or supply of alcohol.

(2) The designated premises supervisor in relation to the premises licence must ensure that the supply of alcohol at the premises is carried on in accordance with the age verification policy.

(3) The policy must require individuals who appear to the responsible person to be under 18 years of age (or such older age as may be specified in the policy) to produce on request, before being served alcohol, identification bearing their photograph, date of birth and either—

- (a) a holographic mark, or
- (b) an ultraviolet feature.

4. Mandatory Condition

The responsible person must ensure that—

(a) where any of the following alcoholic drinks is sold or supplied for consumption on the premises (other than alcoholic drinks sold or supplied having been made up in advance ready for sale or supply in a securely closed container) it is available to customers in the following measures—

- (i) beer or cider: ½ pint;
- (ii) gin, rum, vodka or whisky: 25 ml or 35 ml; and
- (iii) still wine in a glass: 125 ml;

(b) these measures are displayed in a menu, price list or other printed material which is available to customers on the premises; and

(c) where a customer does not in relation to a sale of alcohol specify the quantity of alcohol to be sold, the customer is made aware that these measures are available.

5. Mandatory Condition

1. A relevant person shall ensure that no alcohol is sold or supplied for consumption on or off the premises for a price which is less than the permitted price.

2. For the purposes of the condition set out in paragraph 1—

(a) "duty" is to be construed in accordance with the Alcoholic Liquor Duties Act 1979;

(b) "permitted price" is the price found by applying the formula—

$$P = D + (D \times V)$$

where—

(i) P is the permitted price,

(ii) D is the amount of duty chargeable in relation to the alcohol as if the duty were charged on the date of the sale or supply of the alcohol, and

(iii) V is the rate of value added tax chargeable in relation to the alcohol as if the value added tax were charged on the date of the sale or supply of the alcohol;

(c) "relevant person" means, in relation to premises in respect of which there is in force a premises licence—

(i) the holder of the premises licence,

(ii) the designated premises supervisor (if any) in respect of such a licence, or

(iii) the personal licence holder who makes or authorises a supply of alcohol under such a licence;

(d) "relevant person" means, in relation to premises in respect of which there is in force a club premises certificate, any member or officer of the club present on the premises in a capacity which enables the member or officer to prevent the supply in question; and

(e) "value added tax" means value added tax charged in accordance with the Value Added Tax Act 1994.

3. Where the permitted price given by Paragraph (b) of paragraph 2 would (apart from this paragraph) not be a whole number of pennies, the price given by that sub-paragraph shall be taken to be the price actually given by that sub-paragraph rounded up to the nearest penny.

4.(1) Sub-paragraph (2) applies where the permitted price given by Paragraph (b) of paragraph 2 on a day ("the first day") would be different from the permitted price on the next day ("the second day") as a result of a change to the rate of duty or value added tax.

(2) The permitted price which would apply on the first day applies to sales or supplies of alcohol which take place before the expiry of the period of 14 days beginning on the second day.

6. Mandatory Condition

- (1) No supply of alcohol may be made under the premises licence-
- (a) at a time when there is no designated premises supervisor in respect of the premises licence, or
 - (b) at a time when the designated premises supervisor does not hold a personal licence or his personal licence is suspended.

(2) Every supply of alcohol under the premises licence must be made or authorised by a person who holds a personal licence.

Annex 2 – Conditions consistent with the operating Schedule

7. All staff shall be trained in the Proof of Age policy and how to identify acceptable means of identification.

8. Appropriate signage shall be displayed in prominent positions inside and outside the premises, informing customers they are being recorded on CCTV.

9. The premises shall operate a zero-tolerance policy to drug use and posters shall be prominently displayed to this effect.

10. All staff shall be trained in conflict management and how to refuse alcohol sales.

11. High Definition CCTV shall be installed, operated and maintained, at all times that the premises are open for licensable activities and;

- o shall be checked every two weeks to ensure that the system is working properly and that the date and time are correct. A record of these checks, showing the date and name of the person checking, shall be kept and made available to Police or authorised Council officers on request

- o one camera will show a close-up of the entrance to the premises, to capture a clear, full length image of anyone entering.

- o shall cover any internal or external area of the premises where licensable activities take place.

- o recordings shall be in real time and stored for a minimum period of 31 days with date and time stamping.

- o footage shall be provided free of charge to Police or authorised council officer within 24 hours of a request.

- o a staff member from the premises that is conversant with the operation of the CCTV system shall be on the premises at all times. This staff member will be able to show police or authorised officers of the Licensing Authority recent data footage with the minimum of delay when requested. This data or footage reproduction shall be almost instantaneous.

12. All staff responsible for selling alcohol shall receive regular training in the Licensing Act 2003 in terms of the licensing objectives, offences committed under the Act and conditions of the Premises Licence. Written records of this training shall be retained and made available to police and authorised officers of the Licensing Authority on request.

13. The premises shall operate a 'Challenge 25' age-restricted sales policy and promote it through the prominent display of posters.

14. The licence holder shall require staff to note any refusals in a refusals log. The refusals log shall record the date and time of the refusal; the name of the staff member refusing; and the reason for refusal. It must be checked and signed monthly by the designated premises supervisor. The refusals log shall be made available for inspection upon request by the Licensing Team, Police or Trading Standards.

15. Any alcohol sold for consumption off the premises shall be sold in a sealed container.

16. Alcohol supplied for consumption on the premises shall only be supplied with and be ancillary to food to be consumed on the premises at the same time.

17. Alcohol supplied for consumption off the premises shall only be supplied with and be ancillary to food.

18. On days when Chelsea Football Club are playing at home, the premise shall not allow any drinking, or provision of food, in the outside area at the front of the premises for three hours before the advertised kick off time until one hour after the match has been completed.

19. A waste management contract/agreement must be in place to ensure that all on site generated waste will be appropriately stored and collected in the interest of protecting the amenity of the site and the general area from litter, odour and potential vermin/pest nuisance.

Annex 3 – Conditions attached after a hearing by the licensing authority

Signed: 
Authorised Officer

Date: 25.06.2022

Annex 4- Plans:

Please insert plans at page 7

Licensing Act 2003

Premises Licence



Premises Licence Summary

Premises Licence Number: 2022/00861/LAPR

Premises details

Postal address of premises, or if none, OS map reference or description of the premises

East African Cuisine
335 North End Road

Post town: London

Post code: SW6 1NN

Telephone:

Where the licence is time limited the dates:

Not Applicable

Licensable activities authorised by the licence:

Provision of Late Night Refreshment -Both Indoors and Outdoors
Sale of Alcohol Both On and Off the Premises

The licence authorises the carrying out of the following licensable activities on the days and at the times specified below:

Provision of Late Night Refreshment -Both Indoors and Outdoors
Monday to Sunday 23:00 - 00:00

Sale of Alcohol Off the Premises
Monday to Sunday 12:00 - 00:00

Sale of Alcohol On the Premises
Monday to Sunday 12:00 - 23:30

The opening hours of the premises:

Monday to Sunday 08:00 - 00:00

Where the licence authorises supplies of alcohol whether these are on and/or off supplies:

Both on and off the premises

Name, (registered) address, of holder of premises licence:

Mr Minasie Ghebremariam

[REDACTED]

[REDACTED]

[REDACTED]

Registered number of holder, for example company number, charity number (where applicable):

Not Applicable

Name of designated premises supervisor where the premises licence authorises the supply of alcohol:

Mr Minasie Ghebremariam

State whether access to the premises by children is restricted or prohibited:

No Restrictions

Signed: 
Authorised Officer

Date: 25.06.2022

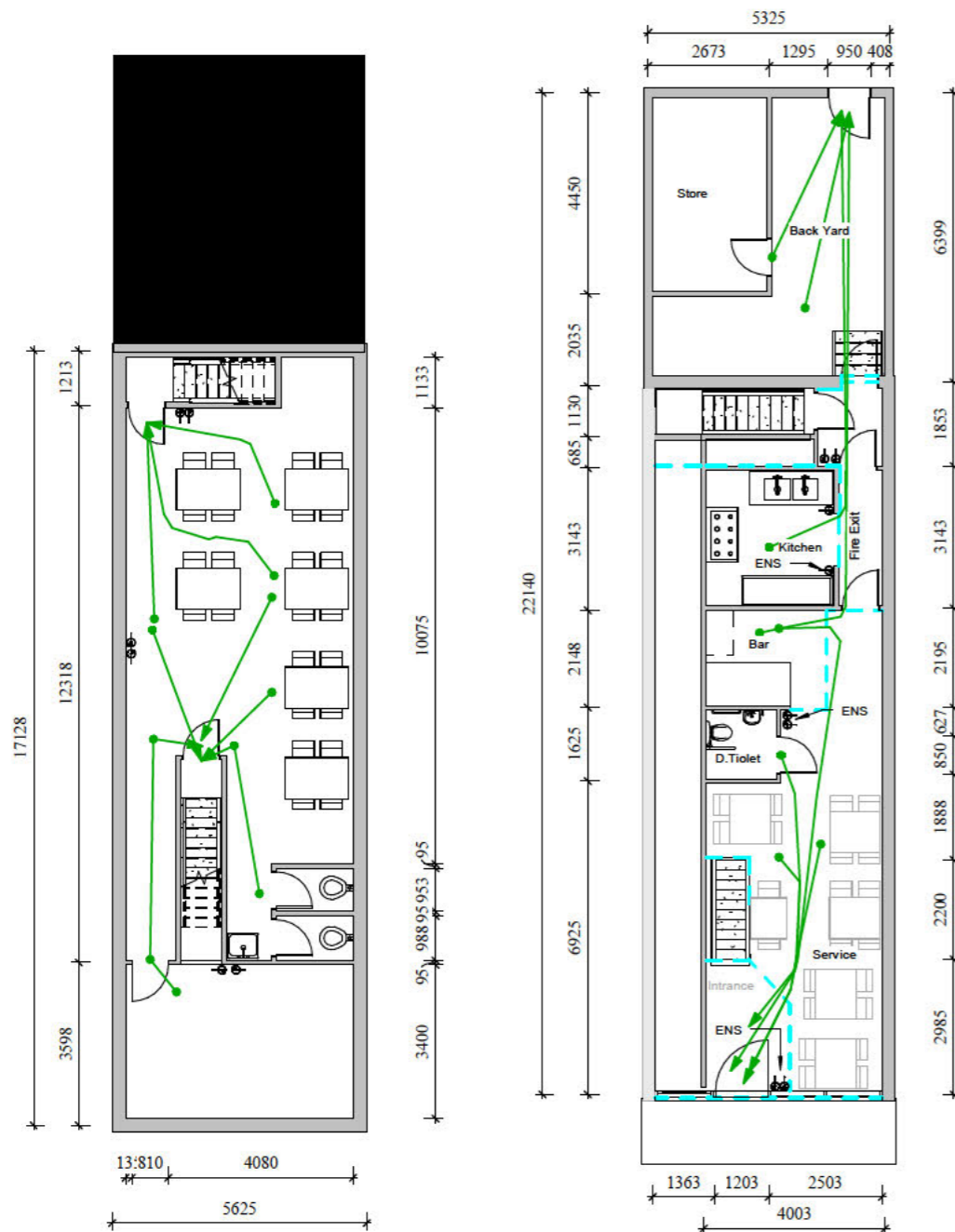

Basement Path Travel Analysis
1 : 100

Level 0 Path Travel Analysis
1 : 100

| FIRE SAFETY EQUIPMENT SCHEDULE | | | | |
|--------------------------------|-------------------------------|--------------|---------------|---------------------------|
| Level | Family | Mark | Assembly Code | Comments |
| Basement | Fire_Extinguisher-Quell_13381 | Black Label | EN3 | CO2 Fire Extinguisher |
| Basement | Fire_Extinguisher-Quell_13381 | Blue Label | EN3 | Dry Powder Extinguisher |
| Basement | Fire_Extinguisher-Quell_13381 | Yellow Label | EN3 | Wet Chemical Extinguisher |
| Basement | Fire_Extinguisher-Quell_13381 | Black Label | EN3 | CO2 Fire Extinguisher |
| Basement | Fire_Extinguisher-Quell_13381 | Blue Label | EN3 | Dry Powder Extinguisher |
| Basement | Fire_Extinguisher-Quell_13381 | Yellow Label | EN3 | Wet Chemical Extinguisher |
| Level 0 Ground Floor | Fire_Extinguisher-Quell_13381 | Black Label | EN3 | CO2 Fire Extinguisher |
| Level 0 Ground Floor | Fire_Extinguisher-Quell_13381 | Blue Label | EN3 | Dry Powder Extinguisher |
| Level 0 Ground Floor | Fire_Extinguisher-Quell_13381 | Yellow Label | EN3 | Wet Chemical Extinguisher |
| Level 0 Ground Floor | Fire_Extinguisher-Quell_13381 | Black Label | EN3 | CO2 Fire Extinguisher |
| Level 0 Ground Floor | Fire_Extinguisher-Quell_13381 | Blue Label | EN3 | Dry Powder Extinguisher |
| Level 0 Ground Floor | Fire_Extinguisher-Quell_13381 | Yellow Label | EN3 | Wet Chemical Extinguisher |
| Level 0 Ground Floor | Fire_Extinguisher-Quell_13381 | Cream Label | EN3 | Foam Fire Extinguisher |
| Level 0 Ground Floor | Fire_Extinguisher-Quell_13381 | Black Label | EN3 | CO2 Fire Extinguisher |

| Path of Travel Schedule | | | | | |
|-------------------------|-------------------------------|----------------|--------|-------|----------|
| Level | View Name | From Room | Length | Time | Speed |
| Level 0 Ground Floor | Level 0 Path Travel Analysis | Service 2 B.01 | 5604 | 4.2 s | 4.8 km/h |
| Level 0 Ground Floor | Level 0 Path Travel Analysis | Service 2 B.01 | 5144 | 3.8 s | 4.8 km/h |
| Level 0 Ground Floor | Level 0 Path Travel Analysis | Service 2 B.01 | 7457 | 5.6 s | 4.8 km/h |
| Level 0 Ground Floor | Level 0 Path Travel Analysis | Service 2 B.01 | 10458 | 7.8 s | 4.8 km/h |
| Level 0 Ground Floor | Level 0 Path Travel Analysis | Service 2 B.01 | 12993 | 9.7 s | 4.8 km/h |
| Level 0 Ground Floor | Level 0 Path Travel Analysis | Service 2 B.01 | 10699 | 8.0 s | 4.8 km/h |
| Level 0 Ground Floor | Level 0 Path Travel Analysis | Back Yard G.07 | 4427 | 3.3 s | 4.8 km/h |
| Level 0 Ground Floor | Level 0 Path Travel Analysis | Back Yard G.07 | 3570 | 2.7 s | 4.8 km/h |
| Basement | Basement Path Travel Analysis | Service 2 B.01 | 4334 | 3.2 s | 4.8 km/h |
| Basement | Basement Path Travel Analysis | Service 2 B.01 | 3089 | 2.3 s | 4.8 km/h |
| Basement | Basement Path Travel Analysis | Service 2 B.01 | 3522 | 2.6 s | 4.8 km/h |
| Basement | Basement Path Travel Analysis | Service 2 B.01 | 5085 | 3.8 s | 4.8 km/h |
| Basement | Basement Path Travel Analysis | Service 2 B.01 | 2174 | 1.6 s | 4.8 km/h |
| Basement | Basement Path Travel Analysis | Service 2 B.01 | 3759 | 2.8 s | 4.8 km/h |
| Basement | Basement Path Travel Analysis | Service 2 B.01 | 4121 | 3.1 s | 4.8 km/h |
| Basement | Basement Path Travel Analysis | Office B.02 | 6885 | 5.1 s | 4.8 km/h |

| No. | Description | Date |
|-----|-------------|------|
| | | |
| | | |
| | | |
| | | |
| | | |
| | | |
| | | |
| | | |
| | | |
| | | |

Minasie GHebreMariam

GILASS CUISINE

Path Travel

| | |
|----------------|---------------|
| Project number | 001 |
| Date | 07/11/2020 |
| Drawn by | Abdalla Idris |
| Checked by | Checker |

A108

| | |
|-------|---------|
| Scale | 1 : 100 |
|-------|---------|