

LOCALITY PLAN

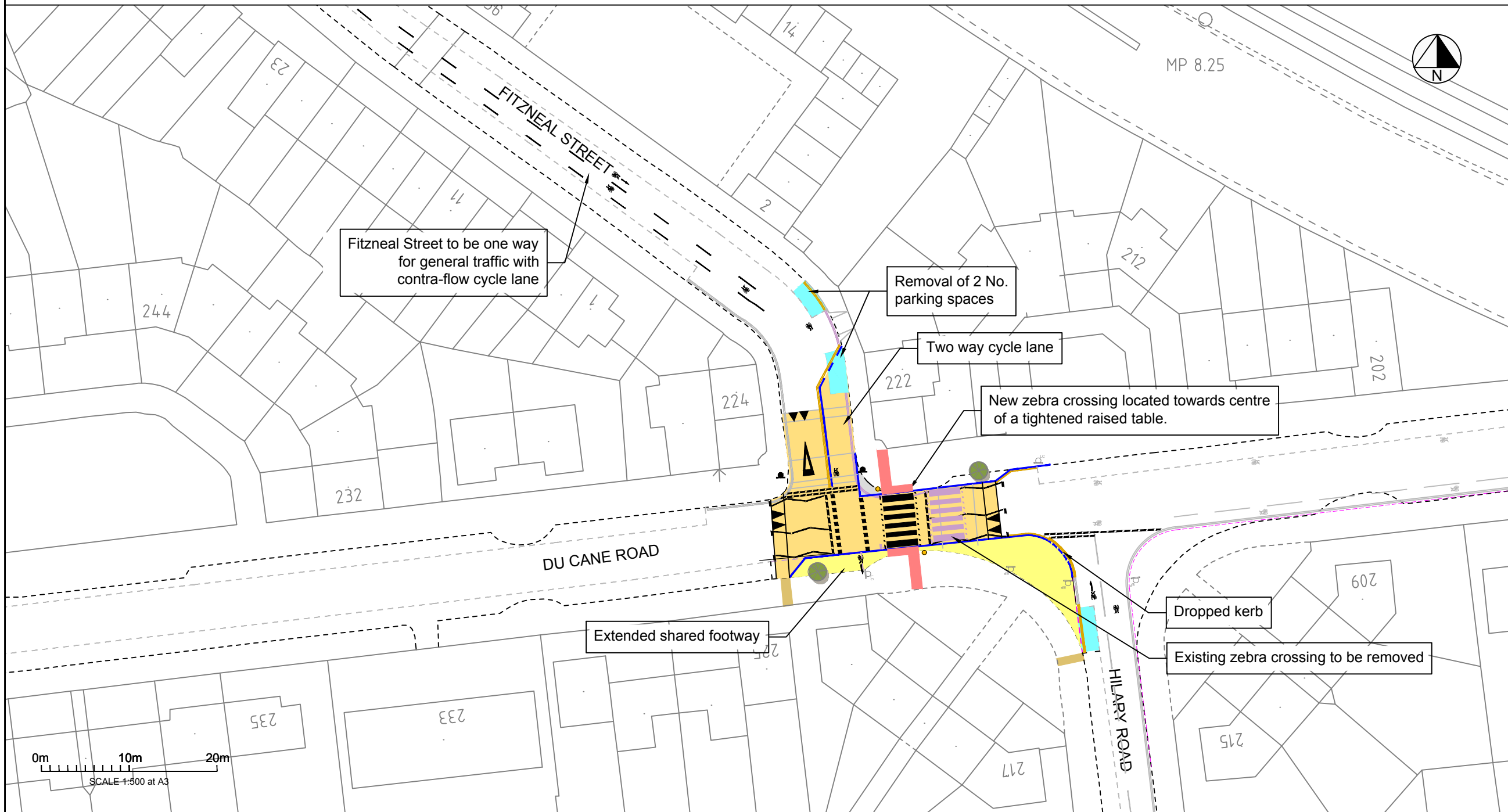
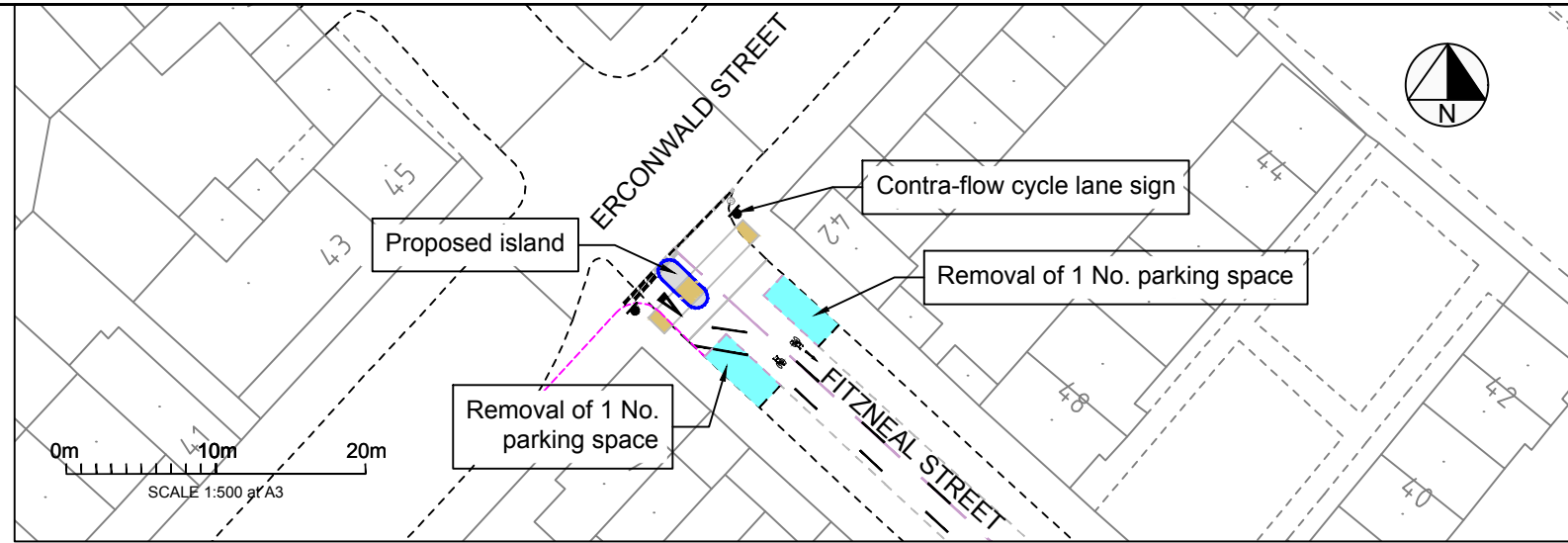

Notes:

1. A raised junction is proposed to slow vehicle speeds where cyclists and pedestrians cross.
2. The width of the junction is narrowed to reduce crossing distance. The extra width is used as a shared area enabling a safe crossing for cyclists and pedestrians.
3. A cycle contraflow on Fitzneal Street is proposed, which ties in with the crossing on Du Cane Road.

Key:

[Grey]	Footway
[Yellow]	Walking/Cycling Space
[Orange]	Raised Table
[Light Blue]	Parking Bay Modification
[Brown]	Shared-Use Tactile Paving
[Pink]	Quietway Route Alignment
[Blue]	Proposed Kerb
[Blue]	Proposed Dropped Kerb
[Black]	Existing Kerb
[Yellow]	Yellow Line Marking
[Green]	Existing / Proposed Tree
[Black]	Sign & Post
[Black]	Lamp Column

Rev	Description	Drawn	Date

Project:
Quietway St. Mark's Road to East Acton

Title:
Fitzneal Street to Hilary Road via Du Cane Road

Drawn: CV
Checked: KI
Date: 03/11/2015
Scale at A3: 1:500

Status:
CONSULTATION

Drawing No: QSMR-C-14-01-01
Revision: -