

Mr Peter Mayhew  
[Redacted]  
[Redacted]  
[Redacted]  
[Redacted]  
[Redacted]

**6 November 2018**  
When telephoning please  
ask for the Licensing  
Section.  
  
E-mail:  
[licensing@lbhf.gov.uk](mailto:licensing@lbhf.gov.uk)

Dear Mr Mayhew

**Licensing Act 2003**

**Premises Licence Number: 2018/01346/LAPR**

**Premises name: Callow Ruscoe**

**Premises address: Basement And Ground Floors 152 Wandsworth  
Bridge Road London SW6 2UH**

Please find enclosed a premises licence following your client's application for a premises licence, this is in two parts; a full licence and a licence summary.

The licence or a certified copy of the licence must be kept at the premises under the control of the holder or another person nominated in writing and be available for examination by the police or an authorised officer.

The licence summary must be prominently displayed at the premises.

I would remind you that;

The licence is not subject to annual renewal and will be in effect until revoked, suspended or surrendered,

An annual maintenance fee is due on the anniversary of the grant of the original licence.

If the licence is for a limited period only, then it will cease to have effect when the stated period expires.

**Data Protection**

Licence holder data is used in accordance with the General Data Protection Regulations. For further details please read the licensing team's Privacy Statement <https://www.lbhf.gov.uk/business/licensing>

Licence holder data is also included in datamatches including the National Fraud Initiative to detect and prevent fraud; for more information go to [www.lbhf.gov.uk/benefits/fraud](http://www.lbhf.gov.uk/benefits/fraud) or call 020 8753 1273

Yours sincerely

Mr Jason Layug

**Licensing Compliance Assistant**

**Encl.** Premises licence – comprising of a full licence and licence summary

# Licensing Act 2003

## Premises Licence



**Premises Licence Number:** 2018/01346/LAPR

### Part 1 – Premises details

#### **Postal address of premises, or if none, OS map reference or description of the premises**

Callow Ruscoe  
152 Wandsworth Bridge Road

**Post town:** London

**Post code:** SW6 2UH

**Telephone:**

#### **Where the licence is time limited the dates:**

Not Applicable

#### **Licensable activities authorised by the licence:**

Sale of Alcohol On and Off the Premises

#### **The licence authorises the carrying out of the following licensable activities on the days and at the times specified below:**

Sale of Alcohol On and Off the Premises  
Monday to Sunday 11:30 -21:00

#### **The opening hours of the premises:**

Monday to Sunday 11:30 -21:00

#### **Where the licence authorises supplies of alcohol whether these are on and / or off supplies:**

Both on and off the premises

## Part 2

### **Name, (registered) address, telephone number and email (where relevant) of holder of premises licence:**

Callow Ruscoe Limited  
3rd Floor  
3 Fitzhardinge Street  
London  
W1H 6EF

**Email:** [bod@callowruscoe.com](mailto:bod@callowruscoe.com)

### **Registered number of holder, for example company number, charity number (where applicable):**

11513868

### **Name, address and telephone number of designated premises supervisor where the premises licence authorises the supply of alcohol:**

Matthew Ward  

**Licensing Authority:** London Borough Of Wandsworth  
**Personal Licence Number:** LBWands/05310

## **Annex 1 – Mandatory Conditions**

### 1. Mandatory Condition

(1) The responsible person must ensure that staff on relevant premises do not carry out, arrange or participate in any irresponsible promotions in relation to the premises.

(2) In this paragraph, an irresponsible promotion means any one or more of the following activities, or substantially similar activities, carried on for the purpose of encouraging the sale or supply of alcohol for consumption on the premises—

(a) games or other activities which require or encourage, or are designed to require or encourage, individuals to—

(i) drink a quantity of alcohol within a time limit (other than to drink alcohol sold or supplied on the premises before the cessation of the period in which the responsible person is authorised to sell or supply alcohol), or

(ii) drink as much alcohol as possible (whether within a time limit or otherwise);

(b) provision of unlimited or unspecified quantities of alcohol free or for a fixed or discounted fee to the public or to a group defined by a particular characteristic in a manner which carries a significant risk of undermining a licensing objective;

(c) provision of free or discounted alcohol or any other thing as a prize to encourage or reward the purchase and consumption of alcohol over a period of 24 hours or less in a manner which carries a significant risk of undermining a licensing objective;

(d) selling or supplying alcohol in association with promotional posters or flyers on, or in the vicinity of, the premises which can reasonably be considered to condone, encourage or glamorise anti-social behaviour or to refer to the effects of drunkenness in any favourable manner;

(e) dispensing alcohol directly by one person into the mouth of another (other than where that other person is unable to drink without assistance by reason of disability).

## 2. Mandatory Condition

The responsible person shall ensure that free potable water is provided on request to customers where it is reasonably available.

## 3. Mandatory Condition

1) The premises licence holder or club premises certificate holder must ensure that an age verification policy is adopted in respect of the premises in relation to the sale or supply of alcohol.

(2) The designated premises supervisor in relation to the premises licence must ensure that the supply of alcohol at the premises is carried on in accordance with the age verification policy.

(3) The policy must require individuals who appear to the responsible person to be under 18 years of age (or such older age as may be specified in the policy) to produce on request, before being served alcohol, identification bearing their photograph, date of birth and either—

- (a) a holographic mark, or
- (b) an ultraviolet feature.

## 4. Mandatory Condition

The responsible person must ensure that—

(a) where any of the following alcoholic drinks is sold or supplied for consumption on the premises (other than alcoholic drinks sold or supplied having been made up in advance ready for sale or supply in a securely closed container) it is available to customers in the following measures—

- (i) beer or cider: ½ pint;
- (ii) gin, rum, vodka or whisky: 25 ml or 35 ml; and
- (iii) still wine in a glass: 125 ml;

(b) these measures are displayed in a menu, price list or other printed material which is available to customers on the premises; and

(c) where a customer does not in relation to a sale of alcohol specify the quantity of alcohol to be sold, the customer is made aware that these measures are available.

## 5. Mandatory Condition

1. A relevant person shall ensure that no alcohol is sold or supplied for consumption on or off the premises for a price which is less than the permitted price.

2. For the purposes of the condition set out in paragraph 1—

(a) "duty" is to be construed in accordance with the Alcoholic Liquor Duties Act 1979;

(b) "permitted price" is the price found by applying the formula—

$$P = D + (D \times V)$$

where—

(i) P is the permitted price,

(ii) D is the amount of duty chargeable in relation to the alcohol as if the duty were charged on the date of the sale or supply of the alcohol, and

(iii) V is the rate of value added tax chargeable in relation to the alcohol as if the value added tax were charged on the date of the sale or supply of the alcohol;

(c) "relevant person" means, in relation to premises in respect of which there is in force a premises licence—

(i) the holder of the premises licence,

(ii) the designated premises supervisor (if any) in respect of such a licence, or

(iii) the personal licence holder who makes or authorises a supply of alcohol under such a licence;

(d) "relevant person" means, in relation to premises in respect of which there is in force a club premises certificate, any member or officer of the club present on the premises in a capacity which enables the member or officer to prevent the supply in question; and

(e) "value added tax" means value added tax charged in accordance with the Value Added Tax Act 1994.

3. Where the permitted price given by Paragraph (b) of paragraph 2 would (apart from this paragraph) not be a whole number of pennies, the price given by that sub-paragraph shall be taken to be the price actually given by that sub-paragraph rounded up to the nearest penny.

4.(1) Sub-paragraph (2) applies where the permitted price given by Paragraph (b) of paragraph 2 on a day ("the first day") would be different from the permitted price on the next day ("the second day") as a result of a change to the rate of duty or value added tax.

(2) The permitted price which would apply on the first day applies to sales or supplies of alcohol which take place before the expiry of the period of 14 days beginning on the second day.

## 6. Mandatory Condition

(1) No supply of alcohol may be made under the premises licence-

(a) at a time when there is no designated premises supervisor in respect of the premises licence, or

(b) at a time when the designated premises supervisor does not hold a personal licence or his personal licence is suspended.

(2) Every supply of alcohol under the premises licence must be made or authorised by a person who holds a personal licence.

## **Annex 2 – Conditions consistent with the operating Schedule**

7. CCTV covering all entrances of the premises shall be installed and maintained, enabling frontal identification of persons entering the premises.
8. CCTV shall be working and recording correctly at all times whilst the premises is open for licensable activities and customers remain on the premises. All images shall be stored for a minimum of 31 days with date and time stamping and shall be made available upon the request of a Police or authorised officer of the Licensing Authority.
9. A staff member that is conversant with the operation of the CCTV system shall be on the premises at all times that the premises are open to the public. This staff member shall be able to show police officers data footage within 48 hours of request.
10. The premises shall operate a zero tolerance policy to drug use.
11. Non-intoxicating beverages, including drinking water, shall be available at the premises where alcohol is sold, supplied or sampled.
12. There shall be no more than fifteen patrons permitted to consume alcohol on the premises at any one time.
13. The premises shall operate a Challenge 25 age restricted sales policy and shall display appropriate signage advising customers of this policy.
14. Driving licence, passport and PASS approved proof of age card are the only forms of photographic identification that shall be accepted at the premises.
15. All staff shall be trained regarding the responsible sale of alcohol and how to identify acceptable means of identification.
16. An incident log shall be kept at the premises for a period of at least 12 months and shall be available on request from the police or an authorised officer of the Licensing Authority. The Designated Premises Supervisor shall regularly check this log. The log shall record the following:
  - (a) all crimes reported to the venue
  - (b) any complaints received
  - (c) any faults in the CCTV
  - (d) any refusal of the sale of alcohol and reason the sale was refused
17. The area immediately outside the premises shall be maintained to ensure that any litter associated with the premises is regularly cleared.
18. No noise or vibration associated with the Premises shall give rise to a nuisance.
19. Signs shall be displayed at each exit of the premises requesting patrons to respect the local residents and leave the premises quietly.

**Annex 3 – Conditions attached after a hearing by the licensing authority**

**Signed:**  
**Authorised Officer**





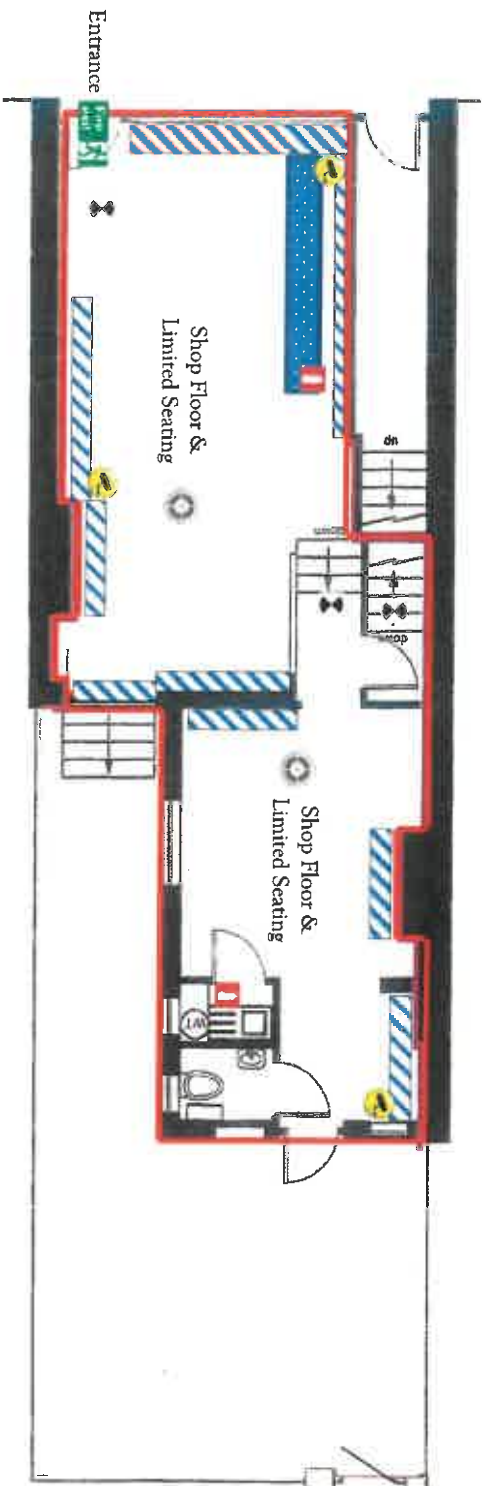

A handwritten signature in blue ink, appearing to be 'C. J. S.', written over the 'Signed:' text.

**Date: 30.10.2018**



# Premises Licence Plan





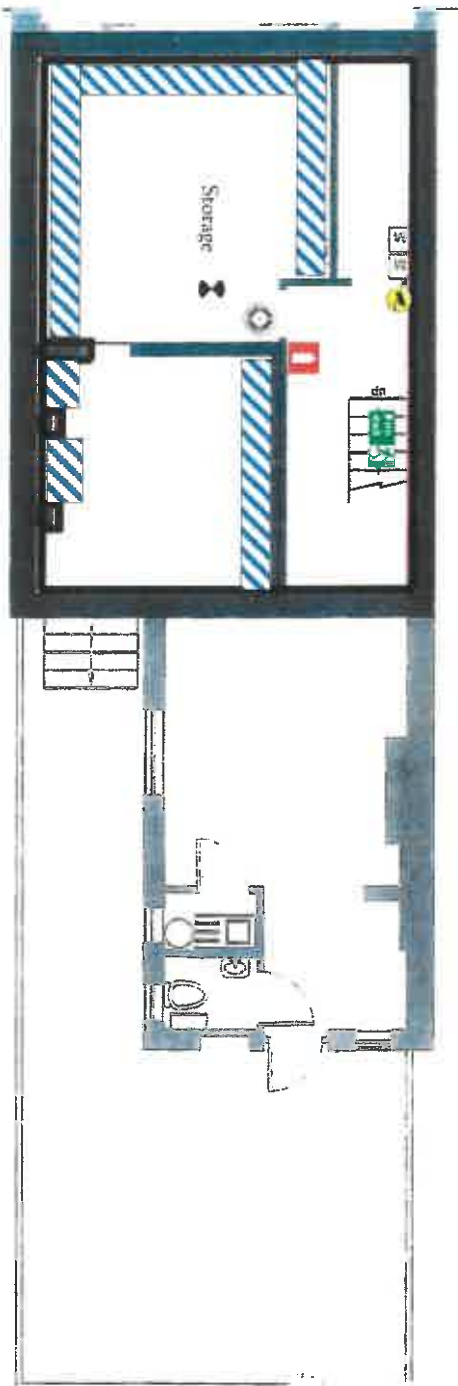

- Key**
- Area Covered by Licence
  -  CCTV Camera
  -  Fire Extinguisher
  -  Smoke / Heat Detector
  -  Emergency Lighting
  -  Counter
  -  Shelving / Fridges

Callow Ruscoe (Ground Floor)  
152 Wandsworth Bridge Road, London SW6 2UH

# Premises Licence Plan



## Key

- Area Covered by Licence
-  CCTV Camera
-  Fire Extinguisher
-  Smoke / Heat Detector
-  Emergency Lighting

 Shelving / Fridges

Callow Ruscoe (Basement)  
152 Wandsworth Bridge Road, London SW6 2UH

# Licensing Act 2003

## Premises Licence



### Premises Licence Summary

**Premises Licence Number:** 2018/01346/LAPR

### Premises details

#### Postal address of premises, or if none, OS map reference or description of the premises

Callow Ruscoe  
152 Wandsworth Bridge Road

**Post town:** London

**Post code:** SW6 2UH

**Telephone:**

#### Where the licence is time limited the dates:

Not Applicable

#### Licensable activities authorised by the licence:

Sale of Alcohol On and Off the Premises

#### The licence authorises the carrying out of the following licensable activities on the days and at the times specified below:

Sale of Alcohol On and Off the Premises  
Monday to Sunday 11:30 -21:00

#### The opening hours of the premises:

Monday to Sunday 11:30 -21:00

#### Where the licence authorises supplies of alcohol whether these are on and / or off supplies:

Both on and off the premises

**Name, (registered) address, of holder of premises licence:**

Callow Ruscoe Limited  
3rd Floor  
3 Fitzhardinge Street  
London  
W1H 6EF

**Registered number of holder, for example company number, charity number (where applicable):**

11513868

**Name of designated premises supervisor where the premises licence authorises the supply of alcohol:**

Matthew Ward

**State whether access to the premises by children is restricted or prohibited:**

No Restrictions

**Signed:**  
**Authorised Officer**



**Date: 30.10.2018**